

## Front seats

### Tools

#### Required special tools and equipment



- ◆ VAS 5094 Airbag adapter

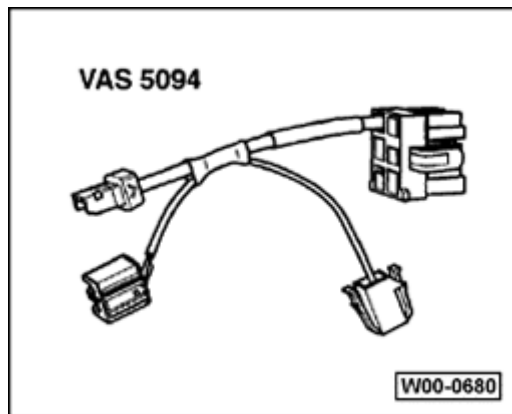

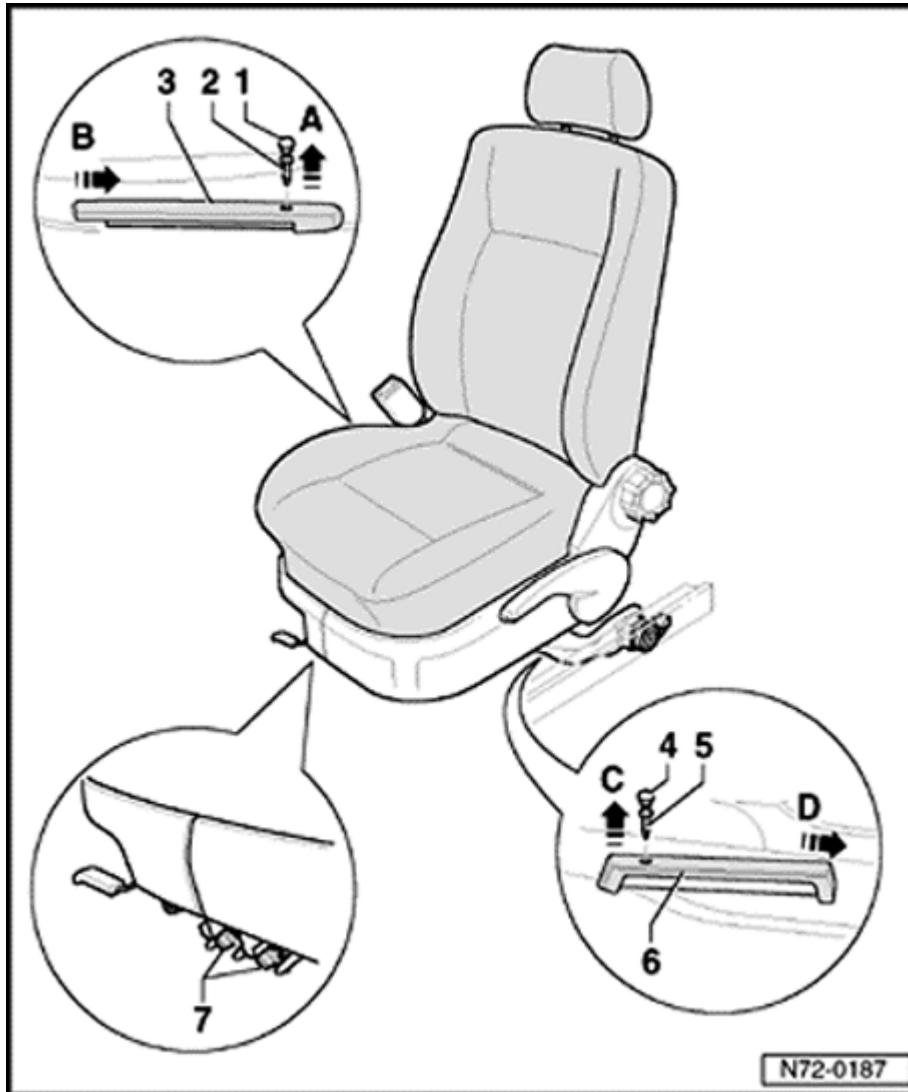

## Front seat, removing and installing

### **CAUTION!**

**Before working on the electrical system, disconnect battery Ground (GND) strap.**

### **Notes:**

- ◆ Depending on variations in vehicle equipment, slight deviations from the removing and installing procedure must be considered.
- ◆ Before disconnecting the battery, obtain radio anti-theft code.
- ◆ After disconnecting the battery make sure that the vehicle equipment (radio, clock and power window regulators) are checked according to repair manual and/or operating instructions.

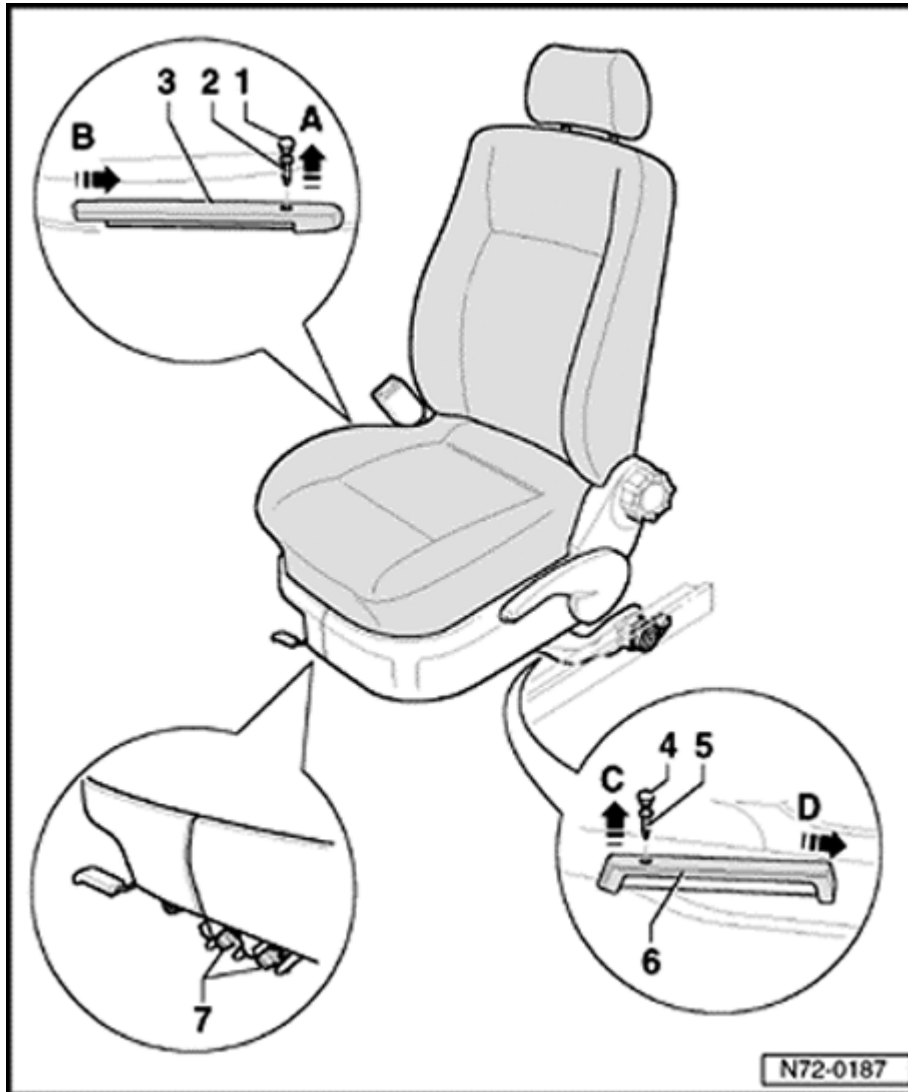

## Removing

- Slide seat forward.
- Unclip cap -1- from tunnel side of cover slip -3-, unscrew screw -2-, unclip cover strip from seat rail (arrow -A-) and remove (arrow -B-).
- Unclip cap -4- from rocker panel side cover strip -6-, unscrew screw -5-, unclip cover strip from seat rail (arrow -C-) and remove (arrow -D-).
- Slide seat backward.
- Unscrew bolts -7- (23 Nm).
- Slide seat to the back out of guide rails.

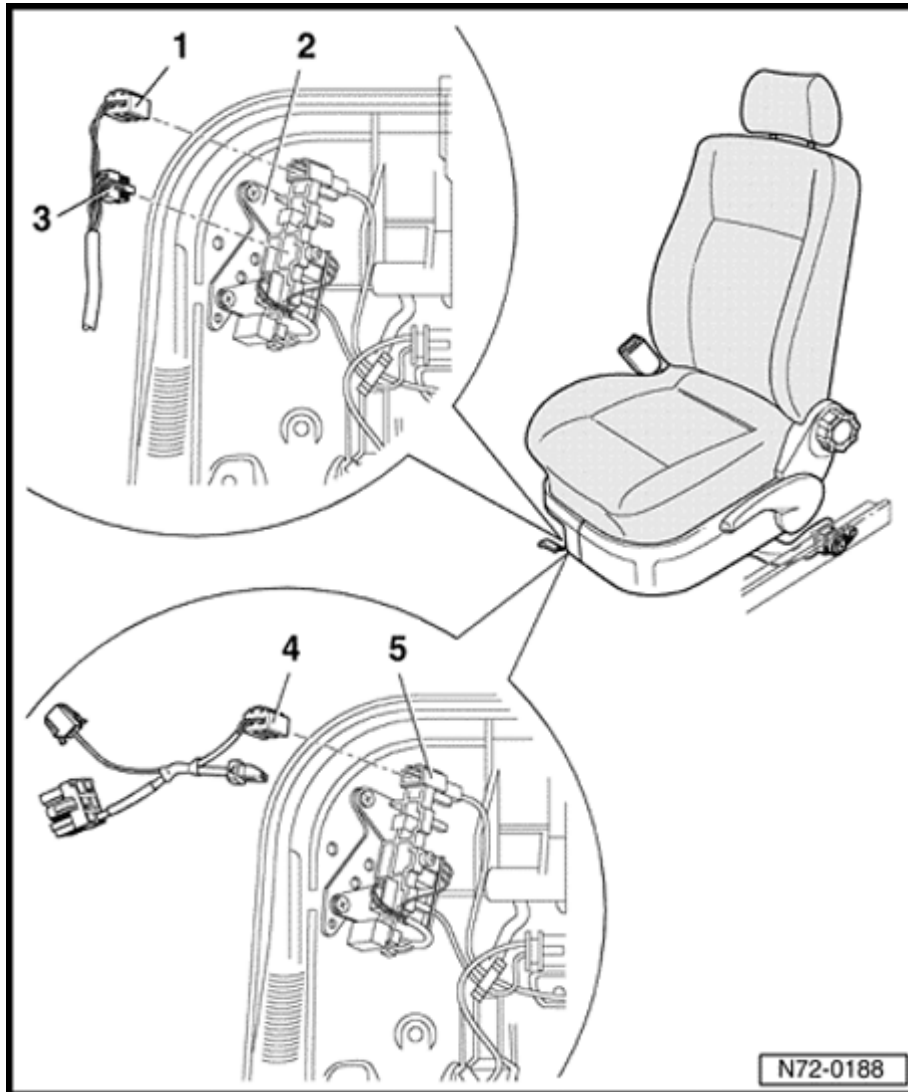
**Note:**

*Before disconnecting ignition and Ground wires, technician must discharge from himself any electrostatic charge (to do this briefly touch striker for door or body).*

- Disconnect connector for side airbag -1- from coupling station -2-.
- Disconnect connector for seat heater -3-, if available, from coupling station.
- Insert connector -4- (airbag adapter VAS 5094) in connector housing -5-.



## Installing

- Install in reverse order of removal.

### **Note:**

*If warning light (K75) for airbag signals a malfunction after assembly, erase DTC memory with Scan Tool VAG 1551 and check again.*

⇒ [Repair Manual, Body On Board Diagnostic \(OBD\), Repair Group 01](#)

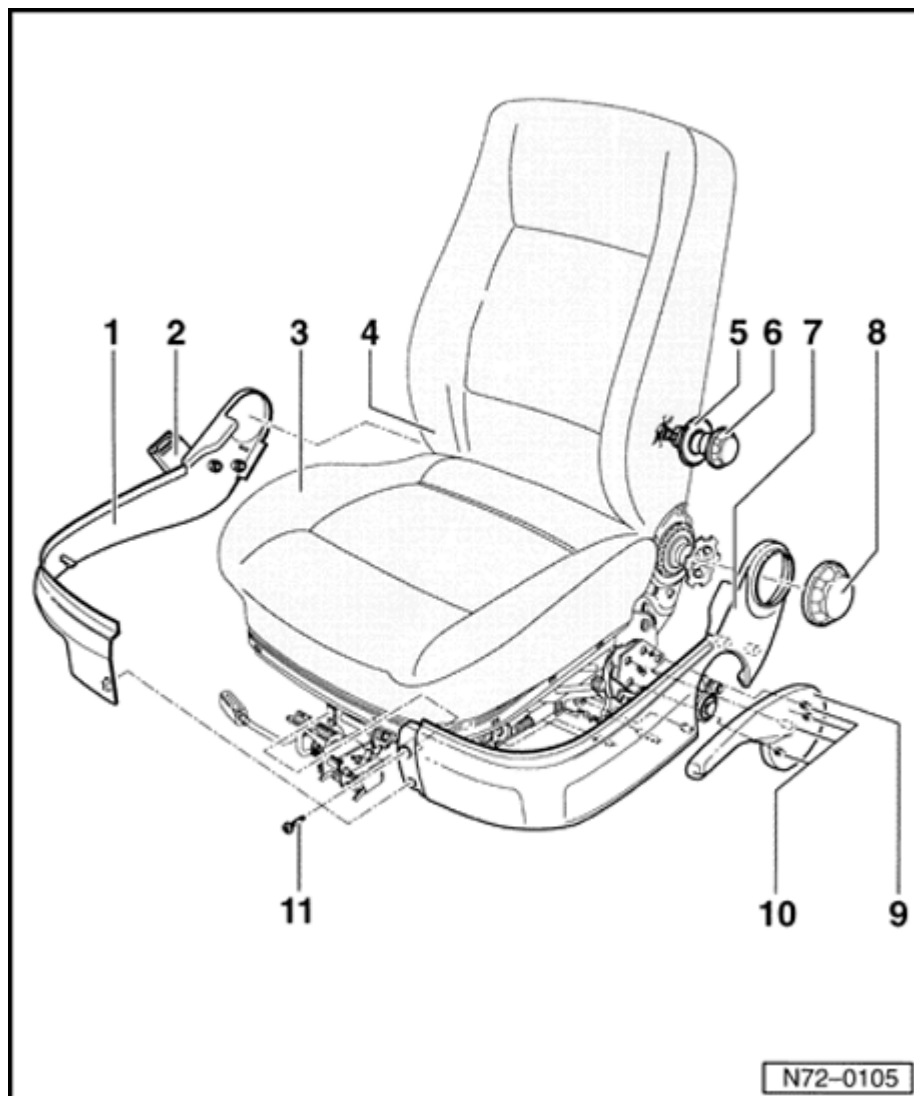

## Front backrest, removing and installing

### Assembly overview - front seat

- 1 - Seat trim, right
- 2 - Belt lock
- 3 - Seat
- 4 - Backrest
- 5 - Trim collar
- 6 - Adjusting knob (lumbar support)
- 7 - Seat trim, left
- 8 - Adjustment knob (backrest)
- 9 - Adjustment lever (Seat height)
- 10 - Expanding pins
- 11 - Screw for left trim



## Removing

- Remove seat ⇒ [page 72-3](#) .

Assembly overview ⇒ [page 72-6](#) .



- Remove belt lock -1-.

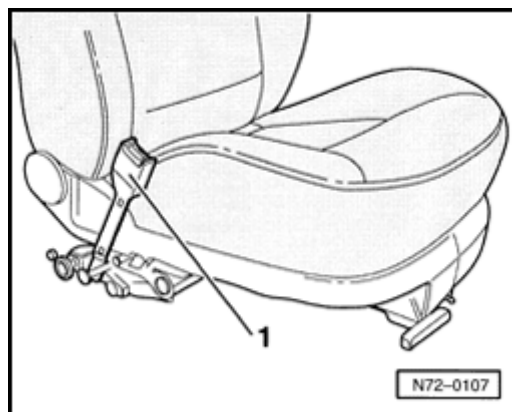

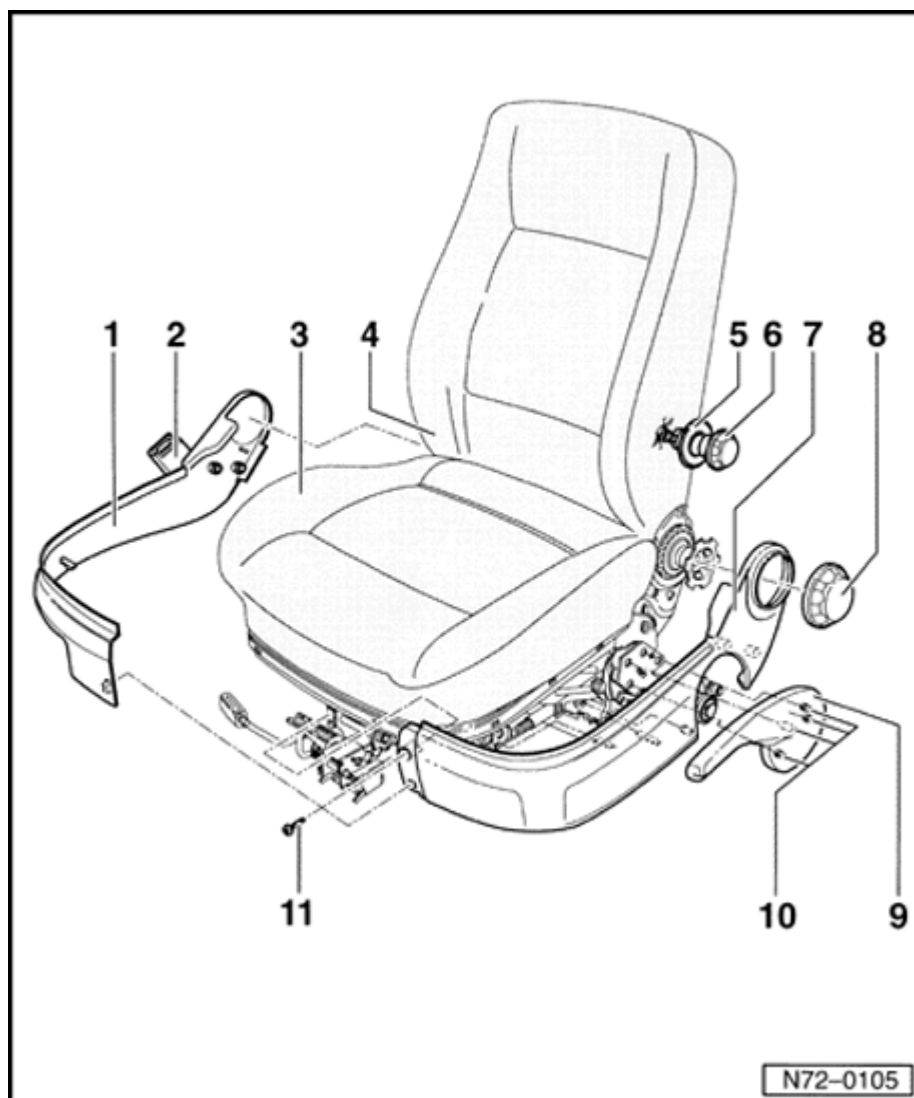

- Remove adjustment knob - 8 -.
- Press four expanding pins - 10 - of adjustment lever - 9 - inward and remove adjustment lever.
- Remove trim - 1 -.
- Remove screw - 11 -.
- Remove trim - 7 -.

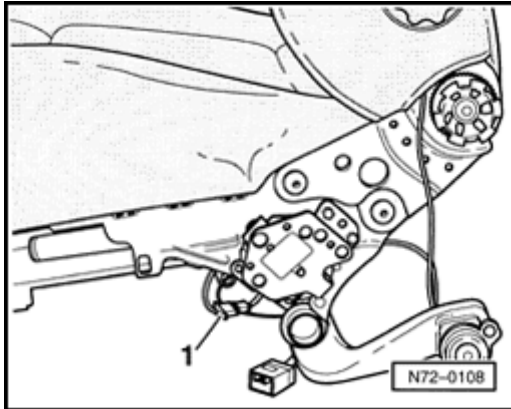

**A**

- Disconnect connector -1- for backrest heater.

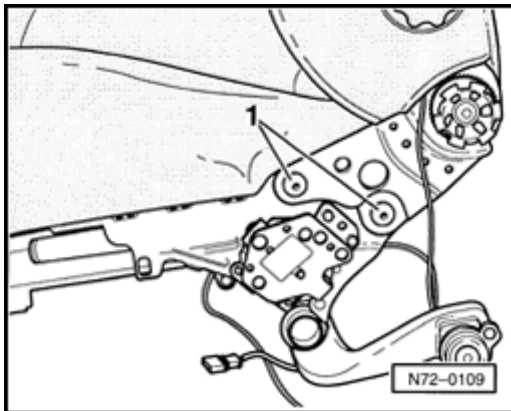
**A**

- Remove screws -1- on both sides of the seat and remove backrest.

### Installing

- Install in reverse order of removal.

### **Note:**

*Screws -1- must be secured with locking fluid D 000 600 A2 (Tightening torque 20 Nm).*

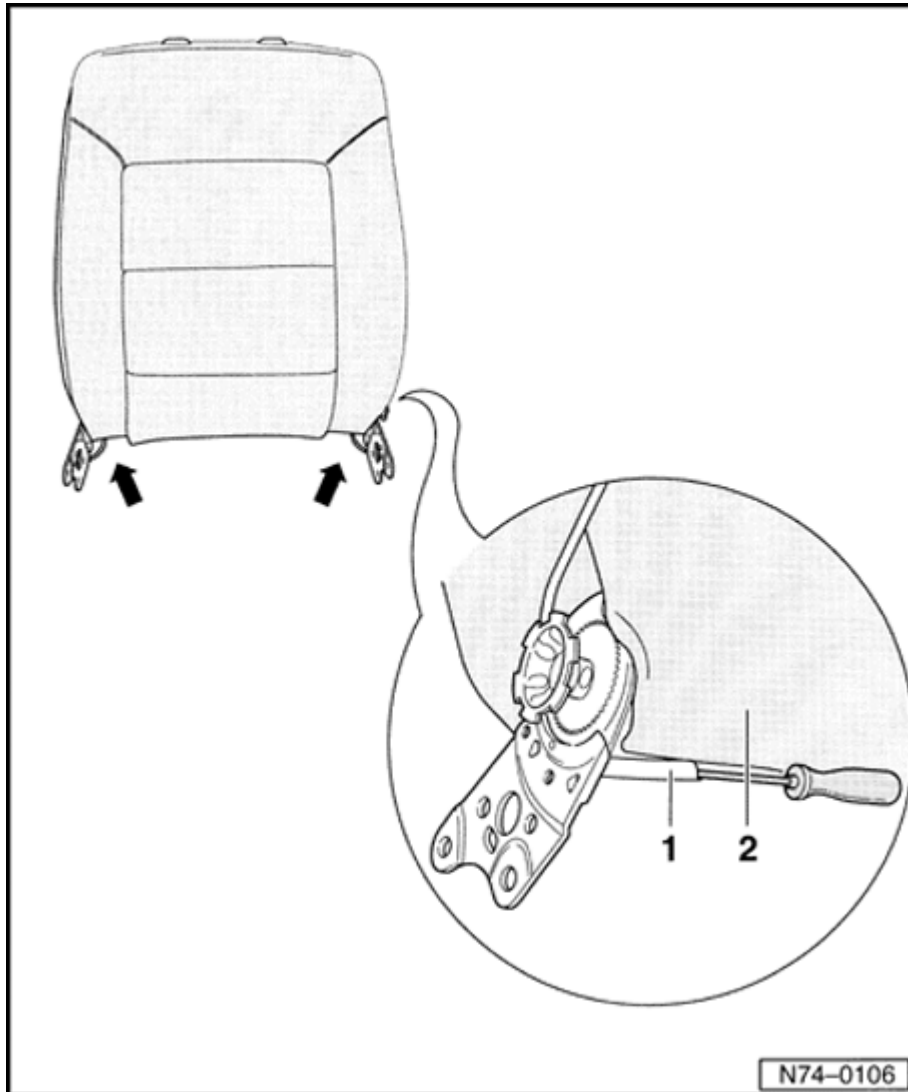

## Lumbar support, removing and installing

### **Note:**

*Lumbar support permits backrest adjustment at lumbar area.*

### **Removing**

- Remove seat ⇒ [page 72-3](#) .
- Remove backrest ⇒ [page 72-6](#) .
- Separate beading strip -1- of cover -2- with screwdriver (arrows).

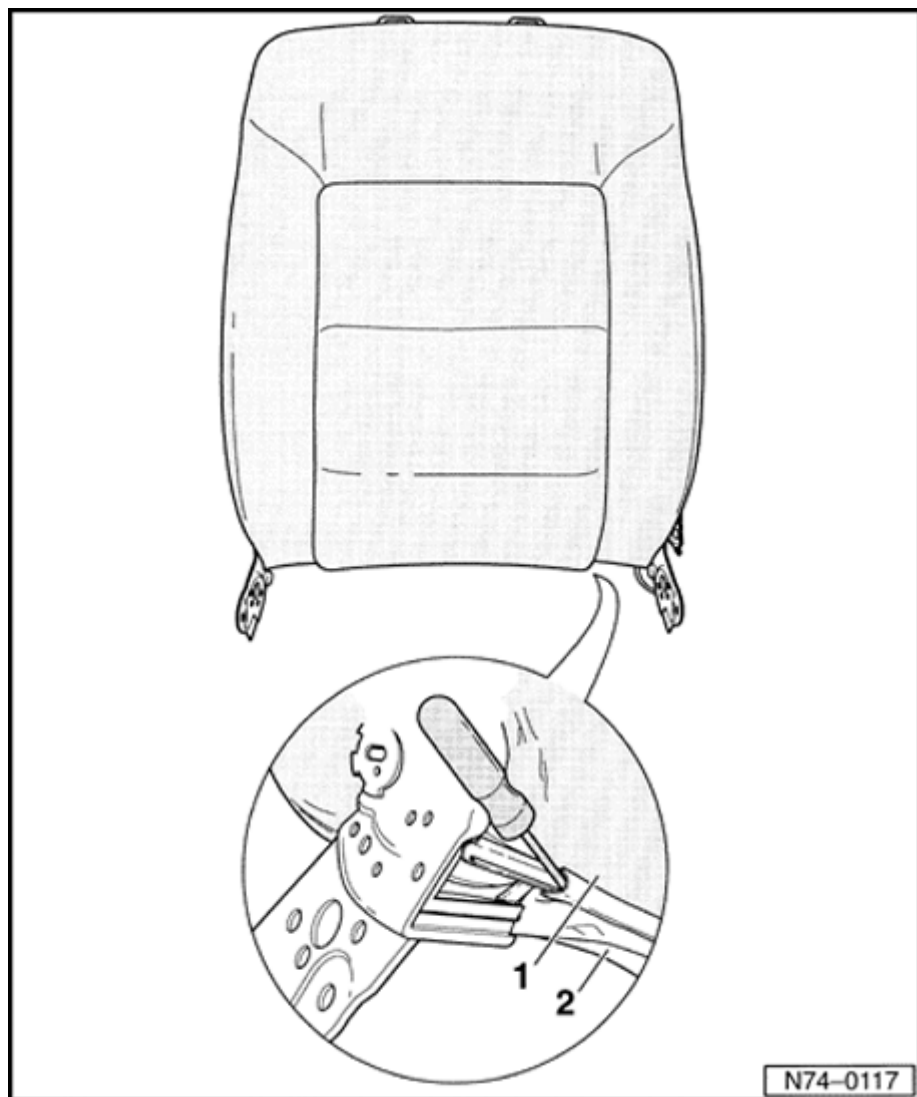

- Loosen rear cover -1- from front cover -2-.

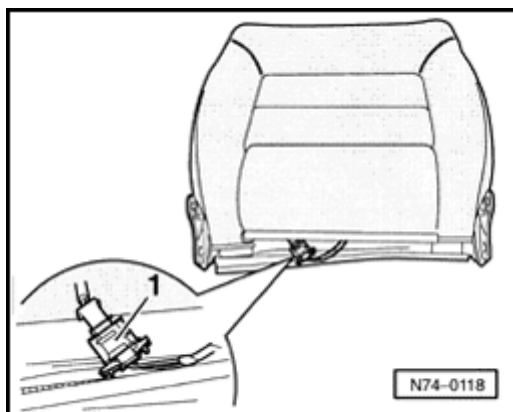

- A - Disconnect connector -1- for backrest heater.

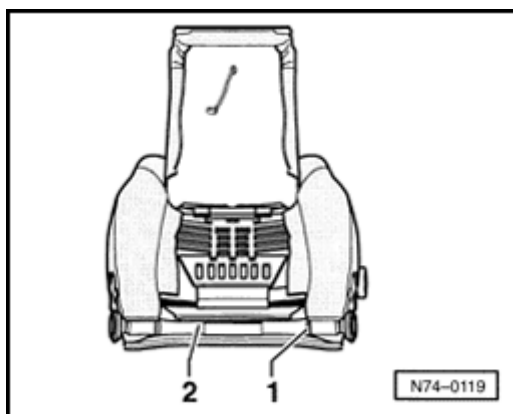

- A - Remove tension wire -1- from seat frame -2-.

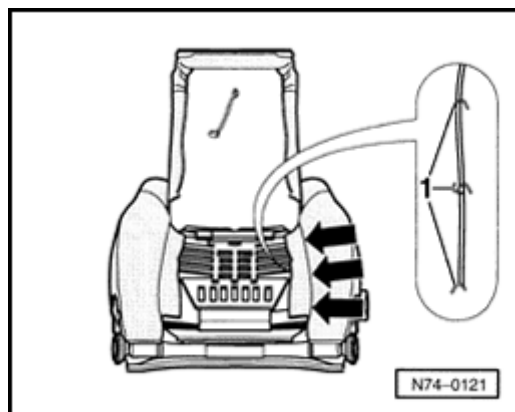

- A - Cut through three upholstery clips-1-.

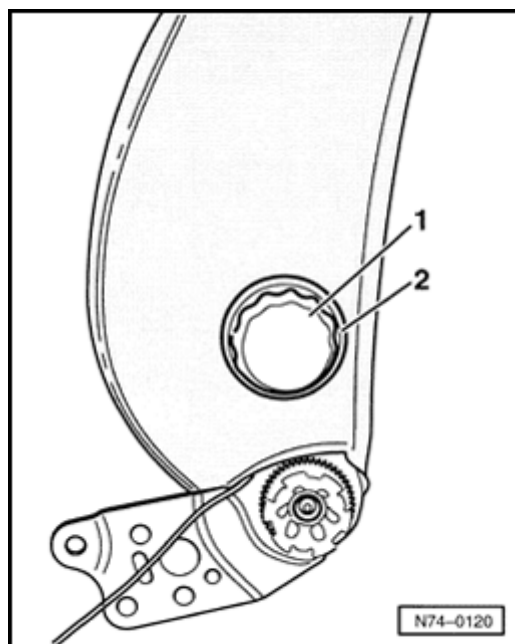

- A - Pry off adjustment knob -1- and trim collar -2-.

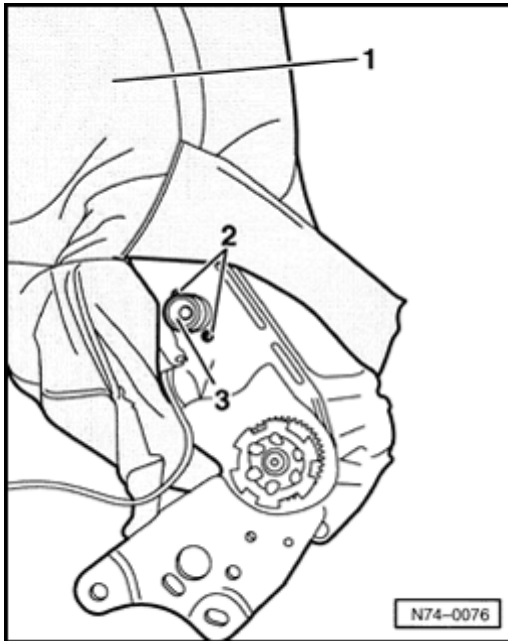
**A**

- Slide up cover -1- and remove screws -2- for lumbar support adjustment -3-.

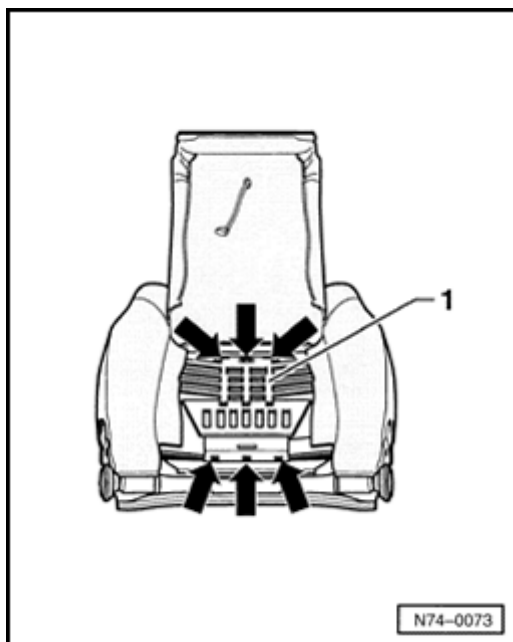

- A
- Unclip lumbar support -1- (arrows) and remove backrest frame.

### Installing

- Install in reverse order of removal.

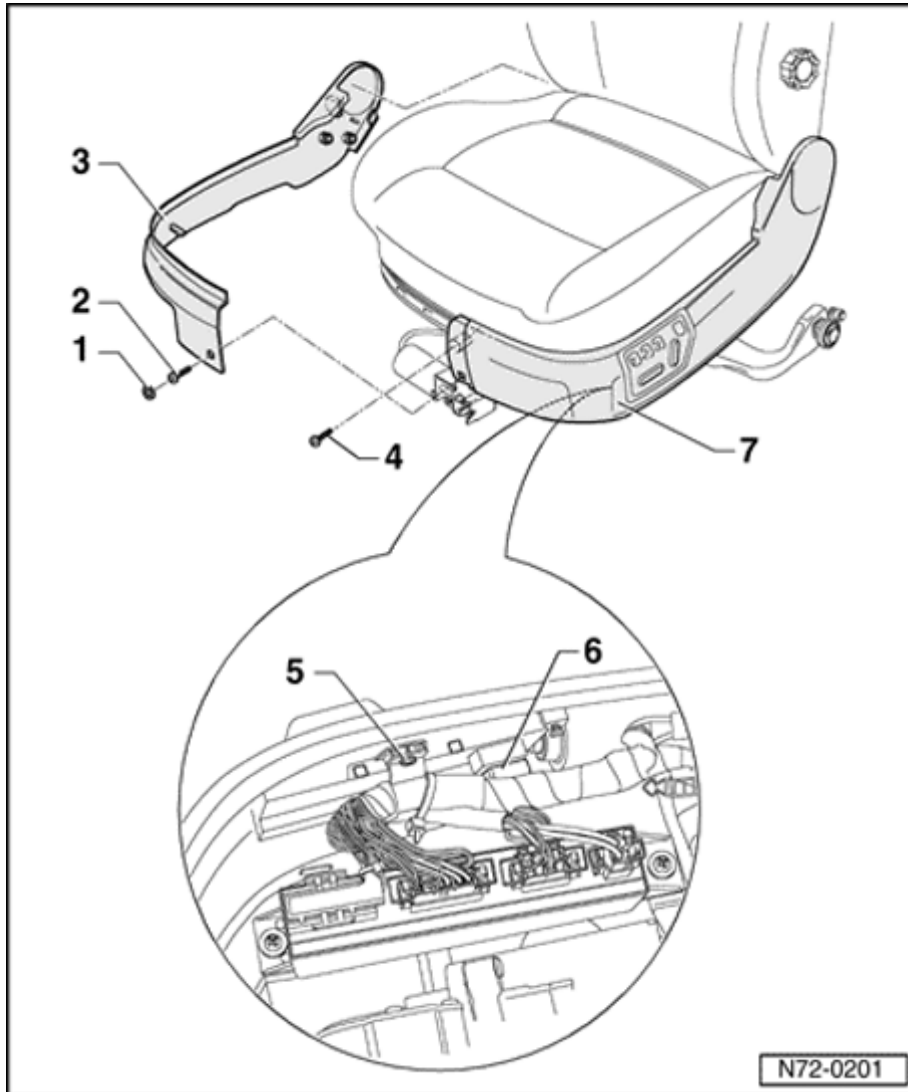

### 8-way seat trim, removing

- Remove seat ⇒ [page 72-3](#) .
- Remove belt lock ⇒ [page 72-7](#) .
- Unclip cap -1- and remove bolt -2-.
- Unclip right seat trim -3-.
- Remove screws -4- and -5-.
- Disconnect connector -6-.
- Unclip left seat trim -7-.



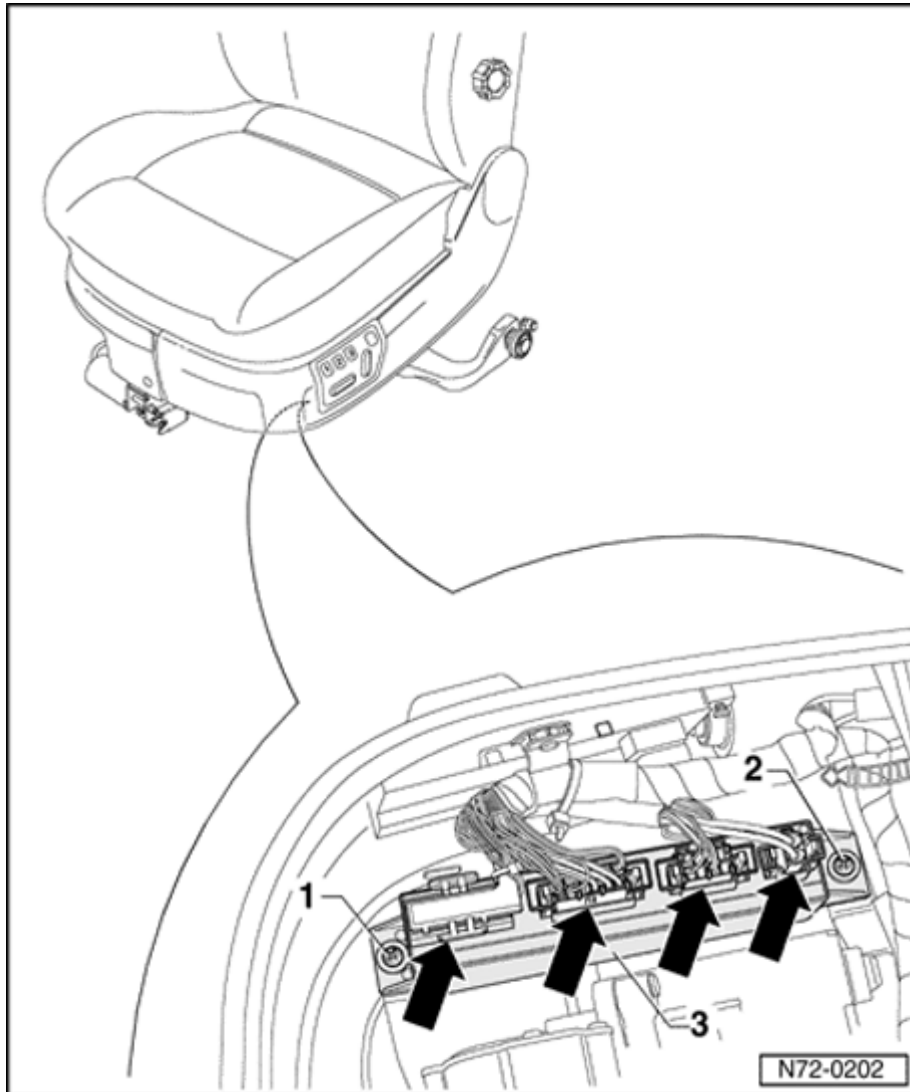

## 8-way seat control module, removing

### **Note:**

*Control module is located under the driver seat.*

- Remove seat ⇒ [page 72-3](#) .
- Disconnect connector -6-.
- Remove screws -1- and -2-.
- Remove control module -3-.

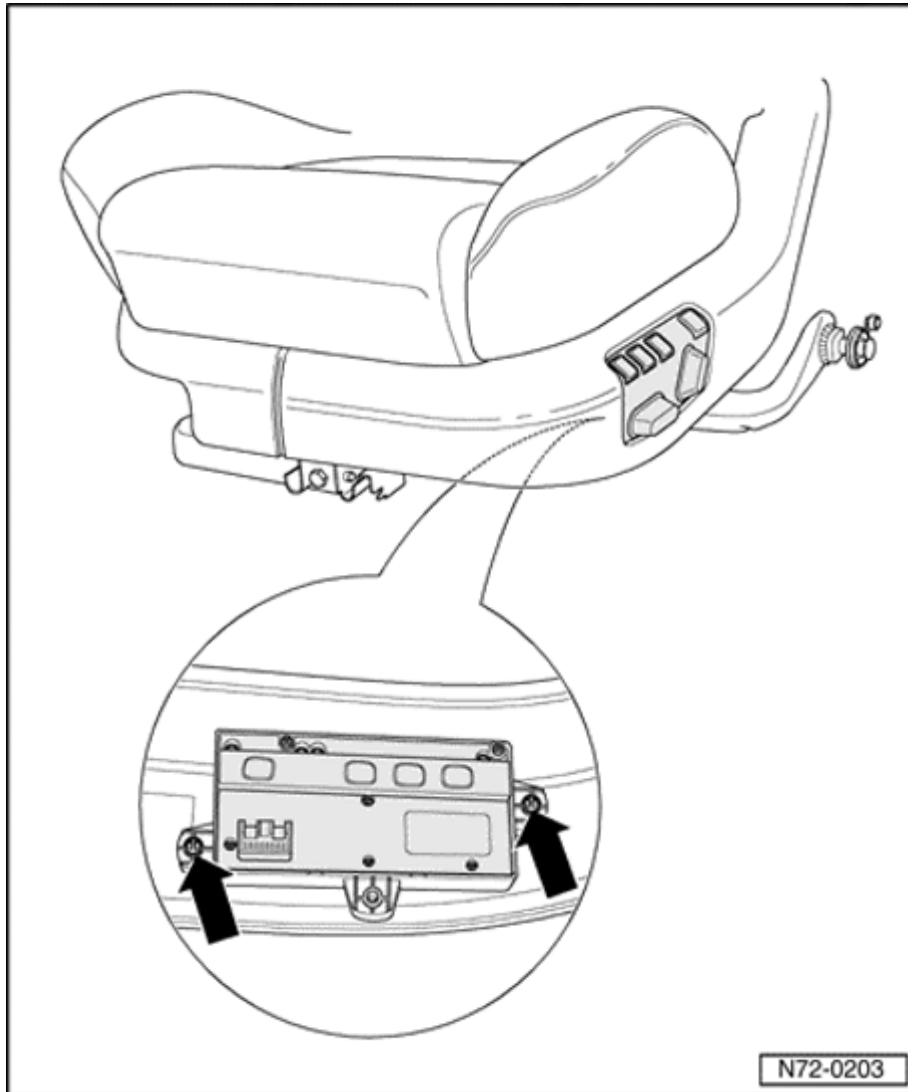

N72-0203

### 8-way seat operating unit, removing

- Remove seat ⇒ [page 72-3](#) .
- Remove 8-way seat trim ⇒ [page 72-16](#) .
- Remove two screws (arrows) on the inner side of the left seat trim and remove operating unit.

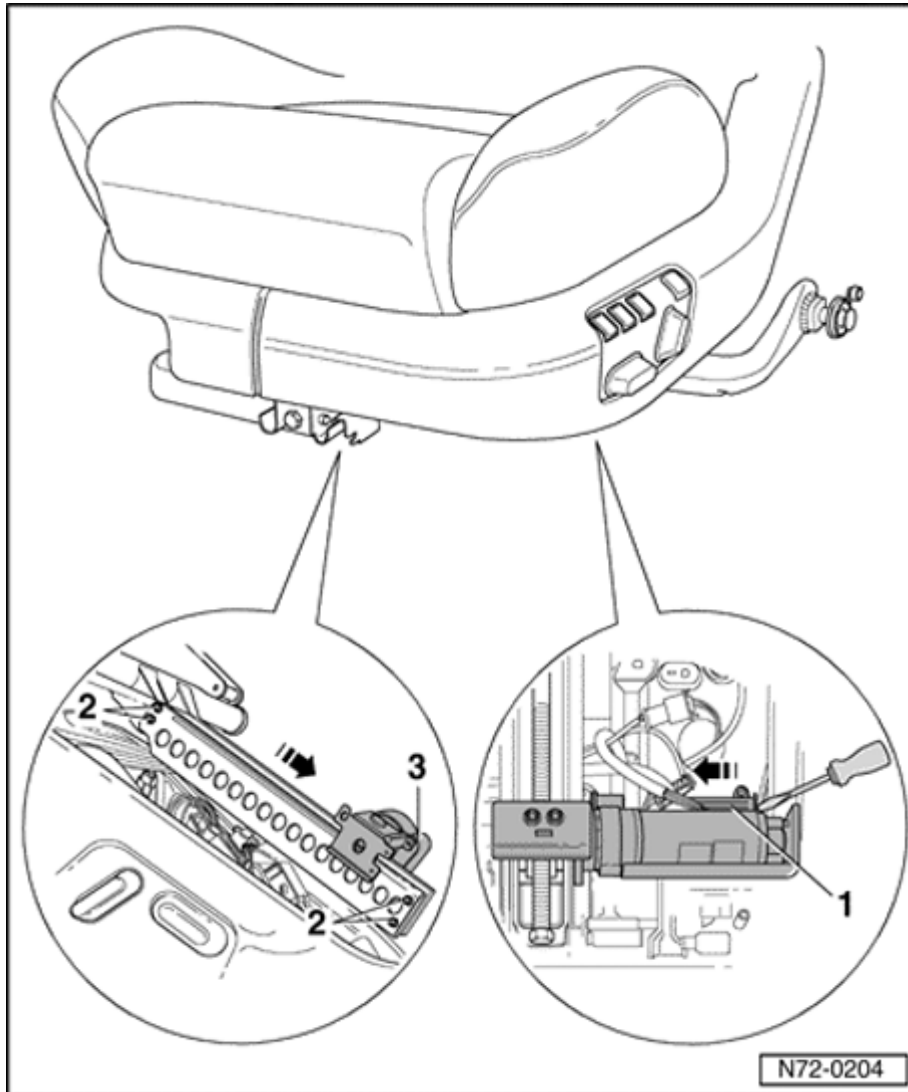

### 8-way seat seat length adjuster, removing

- Remove seat ⇒ [page 72-3](#) .
- Separate connector -1- with a screwdriver in direction of arrow.
- Remove eight screws -2- (four on each side).
- Remove seat length adjuster -3- in direction of arrow.

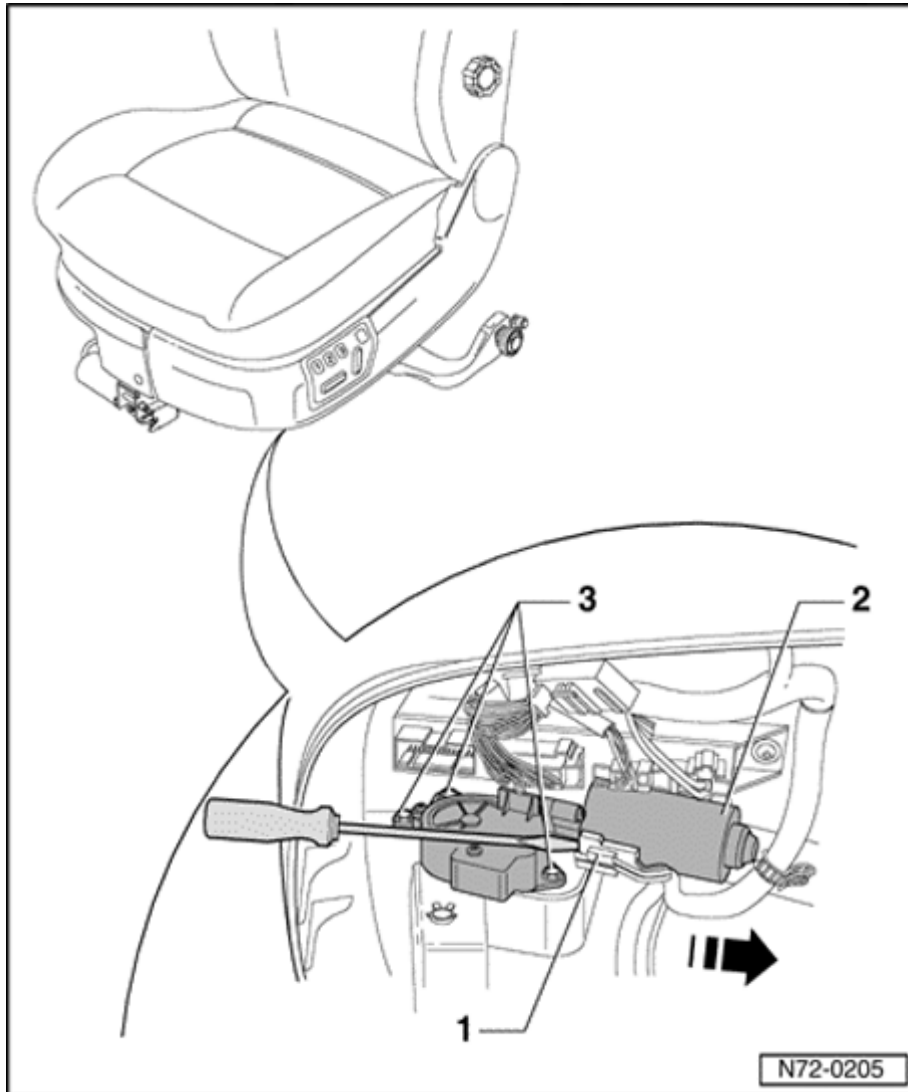

### 8-way seat front drive for seat height adjustment, removing

- Remove seat ⇒ [page 72-3](#) .
- Separate connector -1- with a screwdriver in direction of arrow.
- Remove three bolts -3-.
- Remove front drive -2-.

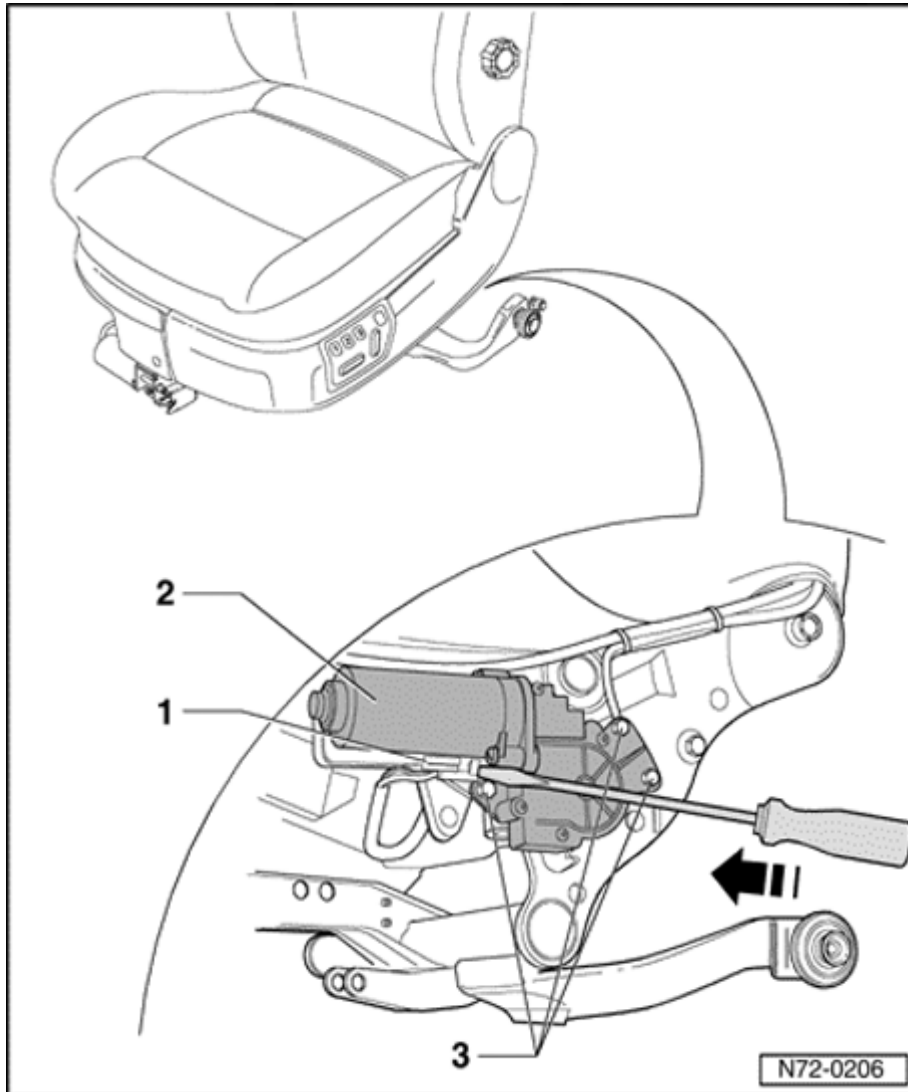

### 8-way seat rear drive for seat height adjustment, removing

- Adjust seat to top most position.
- Remove seat ⇒ [page 72-3](#) .
- Remove trim ⇒ [page 72-16](#) .
- Separate connector -1- with a screwdriver in direction of arrow.
- Remove three bolts -3-.
- Remove rear drive -2-.

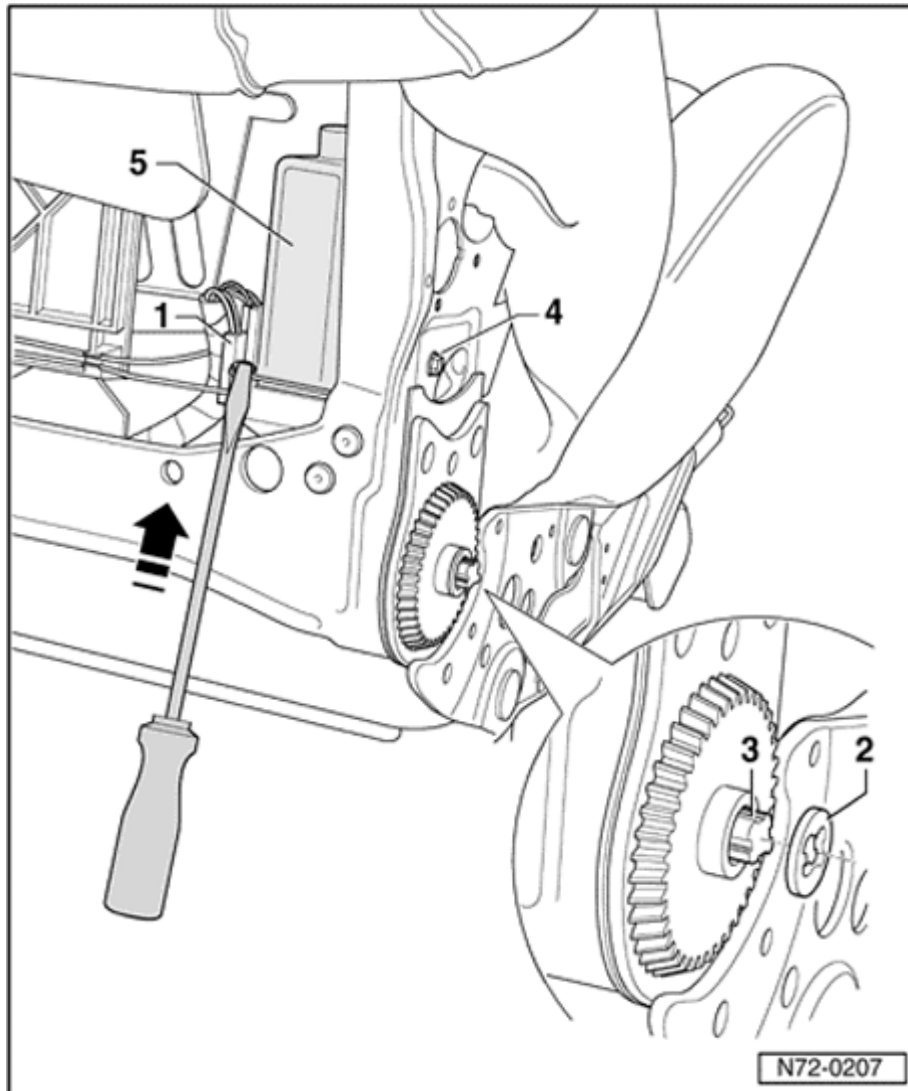

### 8-way seat drive for backrest adjustment, removing

- Remove seat ⇒ [page 72-3](#) .
- Remove trim ⇒ [page 72-16](#) .
- Loosen cover in lower area of backrest and roll up ⇒ [page 74-4](#) .
- Separate connector -1- with a screwdriver in direction of arrow.

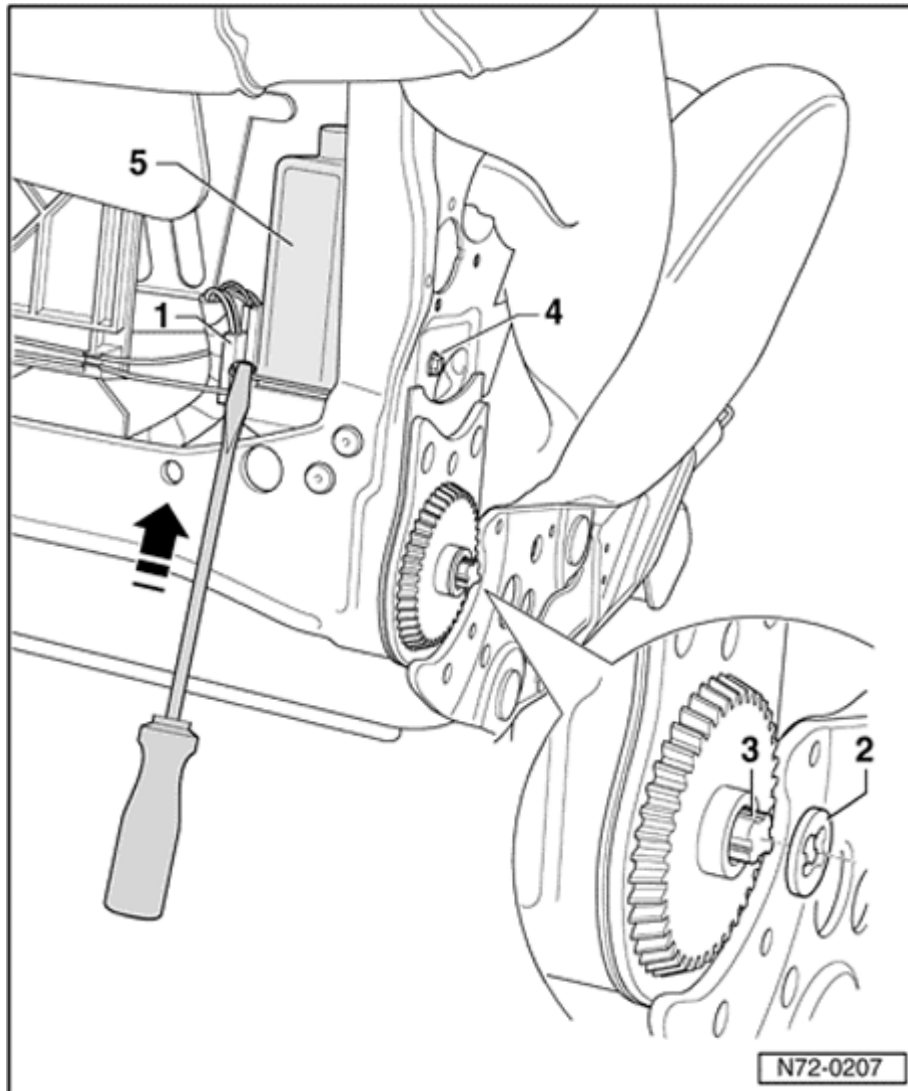

- Pry off locking washer -2- from shaft -3- with a screwdriver.
- Drive out shaft -3- with hammer and mandrel approx. 15 cm in the backrest frame.
- Unscrew nut -4-.
- Remove drive -5-.